

Refer to Schedule 'B' North Perth
Land Use Designations

COUNTY OF PERTH
OFFICIAL PLAN

SCHEDULE 'B'
ATWOOD
LAND USE
DESIGNATIONS

LOT 14
CON VII

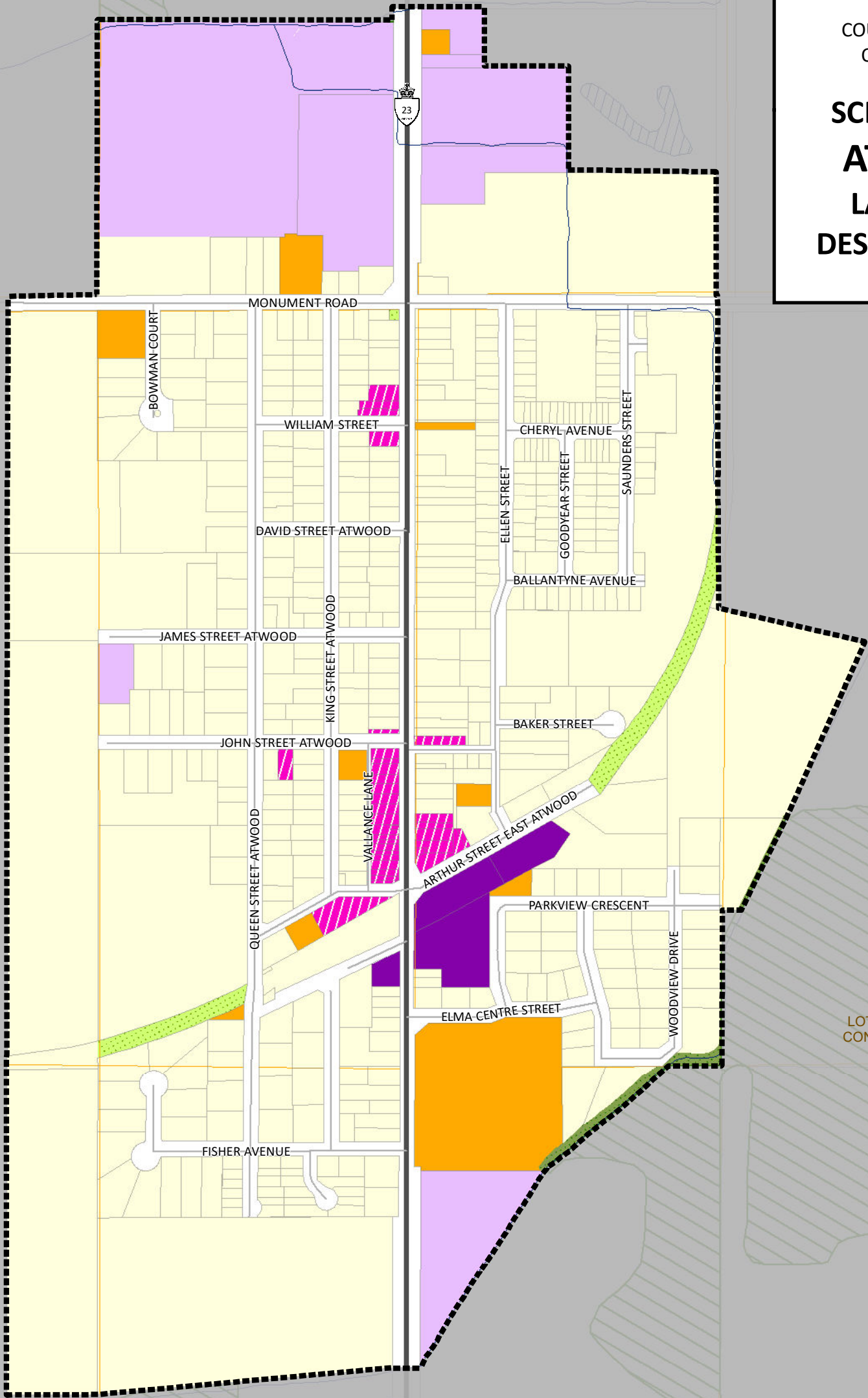

Coordinate System: NAD 1983 UTM Zone 17N
Projection: Transverse Mercator
Datum: North American 1983

LEGEND

Land Use Designations

- Open Space
- Natural Heritage
- Neighbourhood
- Urban Mixed Use
- Corridor Commercial
- Employment

- Institutional
- Natural Heritage Features Overlay

Additional Features

- Provincial Highway
- Local Road
- Watercourse

- Settlement Area Boundary
- Waterbody
- Parcels
- Lots and Concessions

0 75 150 225 m
Scale 1:6,500
1 cm = 65 m



This schedule forms a part of the County of Perth Official Plan and must be read in conjunction with applicable policies of the Plan. For accurate reference recourse should be had to the original document and amendments hereto. The County of Perth does not warrant the accuracy, completeness, content, or currency of the information provided. Contains information licensed under the Open Government Licence – Ontario. This is not a legal Plan of Survey. © The Corporation of Perth County, 2025.

This map may incorporate data under license from:
© King's Printer for Ontario, 2024
© Maitland Valley Conservation Authority, 2024
© Upper Thames River Conservation Authority, 2024
© Grand River Conservation Authority, 2024
© Ausable Bayfield Conservation Authority, 2024

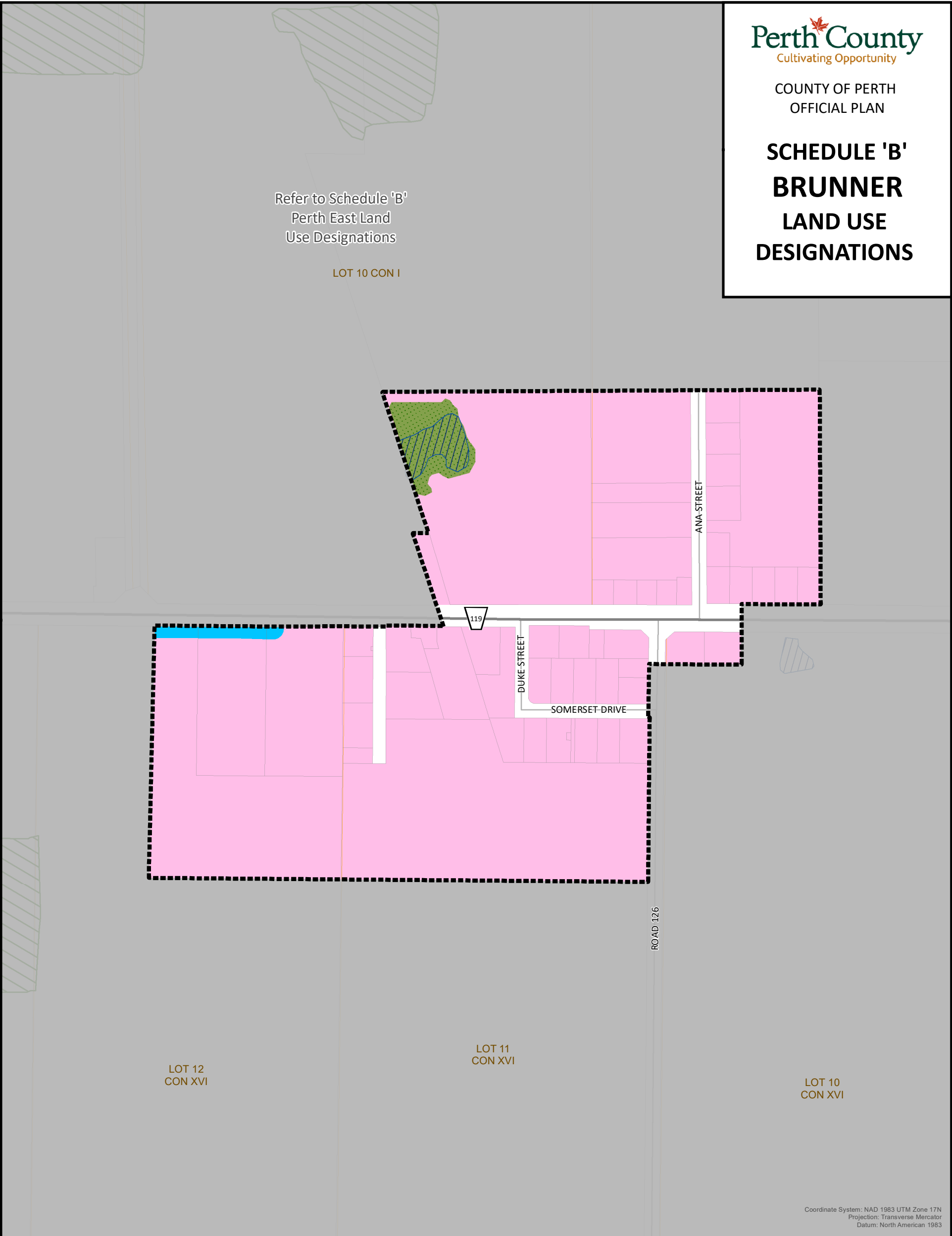

SCHEDULE 'B'
BRUNNER
LAND USE
DESIGNATIONS

Refer to Schedule 'B'
Perth East Land
Use Designations

LOT 10 CON I

LOT 12
CON XVI

LOT 11
CON XVI

LOT 10
CON XVI

Coordinate System: NAD 1983 UTM Zone 17N
Projection: Transverse Mercator
Datum: North American 1983

LEGEND

Land Use Designation

- Village
- Natural Heritage
- Floodplain
- Natural Heritage Features Overlay

Additional Features

- County Road
- Local Road
- Settlement Area Boundary
- Waterbody
- Parcels
- Lots and Concessions

0 60 120 180 m
Scale 1:5,000
1 cm = 50 m



This schedule forms a part of the County of Perth Official Plan and must be read in conjunction with applicable policies of the Plan. For accurate reference recourse should be had to the original document and amendments hereto. The County of Perth does not warrant the accuracy, completeness, content, or currency of the information provided. Contains information licensed under the Open Government Licence – Ontario. This is not a legal Plan of Survey. © The Corporation of Perth County, 2025.

This map may incorporate data under license from:
© King's Printer for Ontario, 2024
© Maitland Valley Conservation Authority, 2024
© Upper Thames River Conservation Authority, 2024
© Grand River Conservation Authority, 2024
© Ausable Bayfield Conservation Authority, 2024

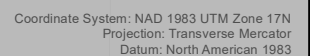

This map may incorporate data under license from:
 © King's Printer for Ontario, 2024
 © Maitland Valley Conservation Authority, 2024
 © Upper Thames River Conservation Authority, 2024
 © Grand River Conservation Authority, 2024
 © Ausable Bayfield Conservation Authority, 2024

SCHEDULE 'B'
GADS HILL
LAND USE
DESIGNATIONS

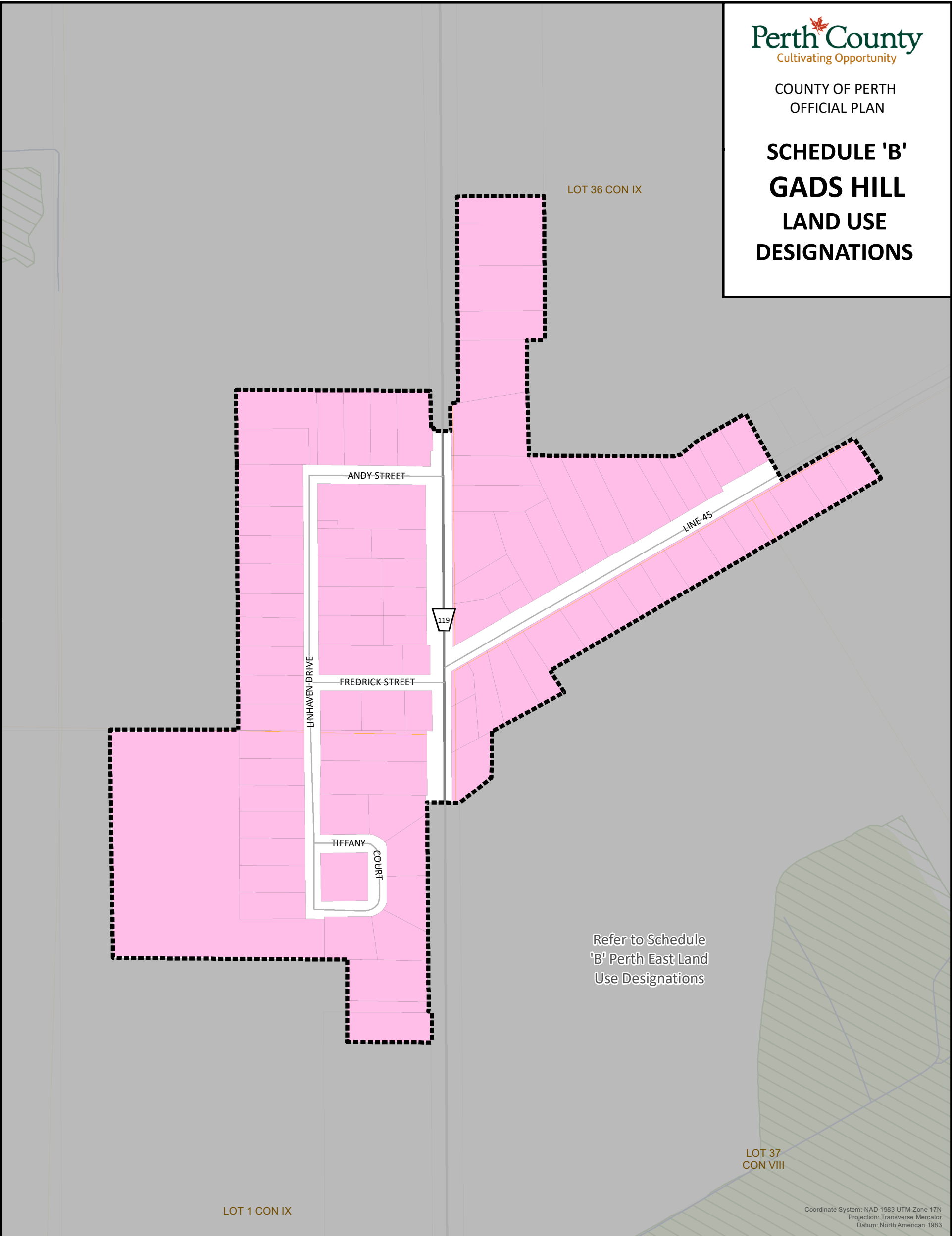

LEGEND

Land Use Designation

- Village
- Natural Heritage Features Overlay

Additional Features

- County Road
- Local Road
- Watercourse

- Settlement Area Boundary
- Parcels
- Lots and Concessions

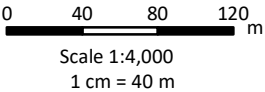

This schedule forms a part of the County of Perth Official Plan and must be read in conjunction with applicable policies of the Plan. For accurate reference recourse should be had to the original document and amendments hereto. The County of Perth does not warrant the accuracy, completeness, content, or currency of the information provided. Contains information licensed under the Open Government Licence – Ontario. This is not a legal Plan of Survey. © The Corporation of Perth County, 2025.

This map may incorporate data under license from:
© King's Printer for Ontario, 2024
© Maitland Valley Conservation Authority, 2024
© Upper Thames River Conservation Authority, 2024
© Grand River Conservation Authority, 2024
© Ausable Bayfield Conservation Authority, 2024

SCHEDULE 'B'
GOWANSTOWN
LAND USE
DESIGNATIONS

Refer to Schedule 'B' North Perth
Land Use Designations

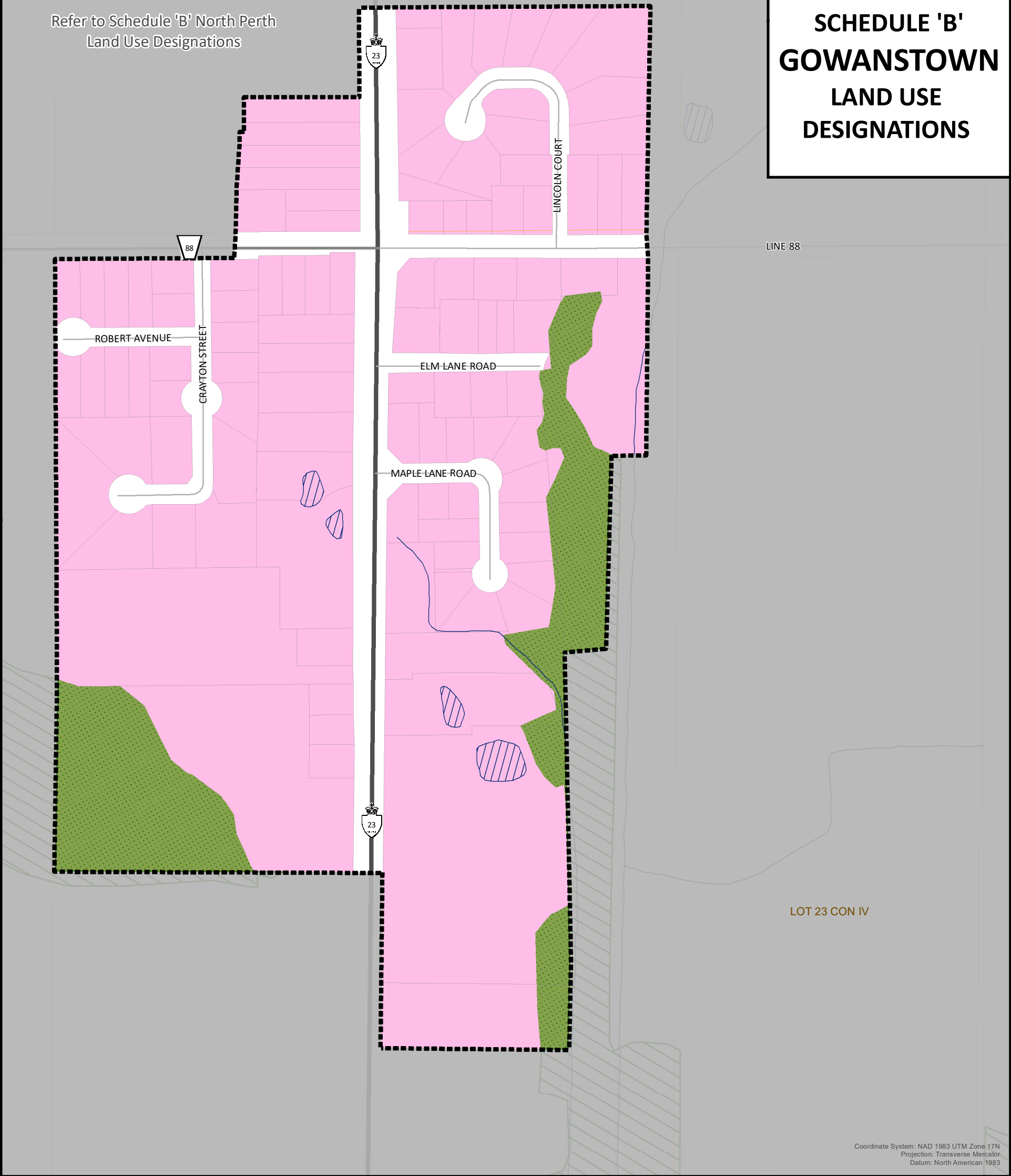

Coordinate System: NAD 1983 UTM Zone 17N
Projection: Transverse Mercator
Datum: North American 1983

LEGEND

Land Use Designations

- Village
- Natural Heritage
- Natural Heritage Features Overlay

Additional Features

- Provincial Highway
- County Road
- Local Road
- Watercourse
- Settlement Area Boundary
- Waterbody
- Parcels
- Lots and Concessions

0 40 80 120 m
Scale 1:4,000
1 cm = 40 m



This schedule forms a part of the County of Perth Official Plan and must be read in conjunction with applicable policies of the Plan. For accurate reference recourse should be had to the original document and amendments hereto. The County of Perth does not warrant the accuracy, completeness, content, or currency of the information provided. Contains information licensed under the Open Government Licence – Ontario. This is not a legal Plan of Survey. © The Corporation of Perth County, 2025.

This map may incorporate data under license from:
© King's Printer for Ontario, 2024
© Maitland Valley Conservation Authority, 2024
© Upper Thames River Conservation Authority, 2024
© Grand River Conservation Authority, 2024
© Ausable Bayfield Conservation Authority, 2024

SCHEDULE 'B'
KIRKTON
LAND USE
DESIGNATIONS

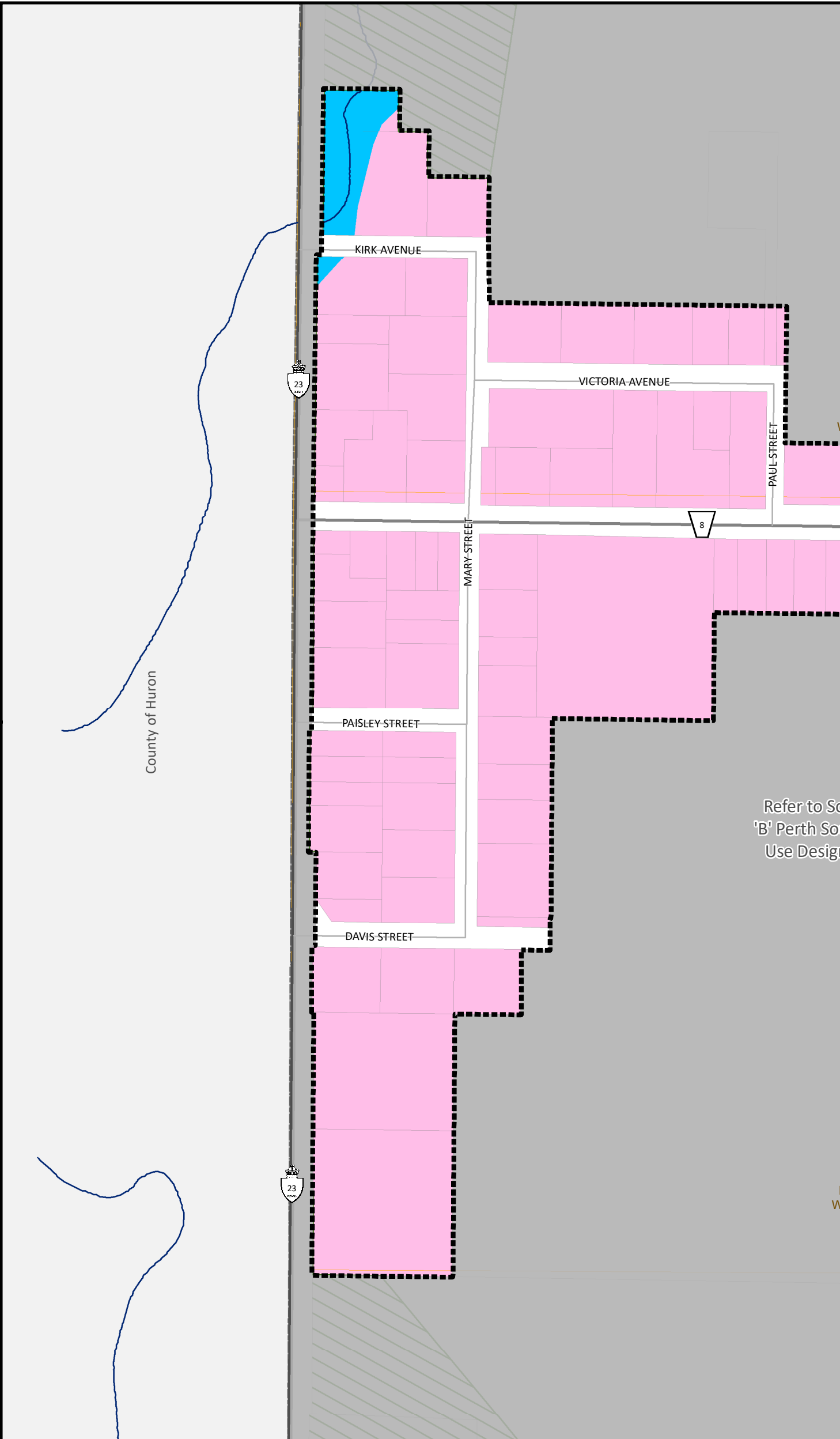

LOT 8 CONCESSION
WESTERN BOUNDARY

Refer to Schedule
'B' Perth South Land
Use Designations

LOT 9 CONCESSION
WESTERN BOUNDARY

Coordinate System: NAD 1983 UTM Zone 17N
Projection: Transverse Mercator
Datum: North American 1983

LEGEND

Land Use Designations

- Village
- Floodplain
- Natural Heritage Features Overlay

Additional Features

- Provincial Highway
- County Road
- Local Road
- Watercourse

- Settlement Area Boundary
- Waterbody
- Parcels
- Lots and Concessions

0 30 60 90 m
Scale 1:3,000
1 cm = 30 m



This schedule forms a part of the County of Perth Official Plan and must be read in conjunction with applicable policies of the Plan. For accurate reference recourse should be had to the original document and amendments hereto. The County of Perth does not warrant the accuracy, completeness, content, or currency of the information provided. Contains information licensed under the Open Government Licence – Ontario. This is not a legal Plan of Survey. © The Corporation of Perth County, 2025.

This map may incorporate data under license from:
© King's Printer for Ontario, 2024
© Maitland Valley Conservation Authority, 2024
© Upper Thames River Conservation Authority, 2024
© Grand River Conservation Authority, 2024
© Ausable Bayfield Conservation Authority, 2024

SCHEDULE 'B'
LISTOWEL
LAND USE
DESIGNATIONS

Refer to Schedule 'B' North Perth
Land Use Designations

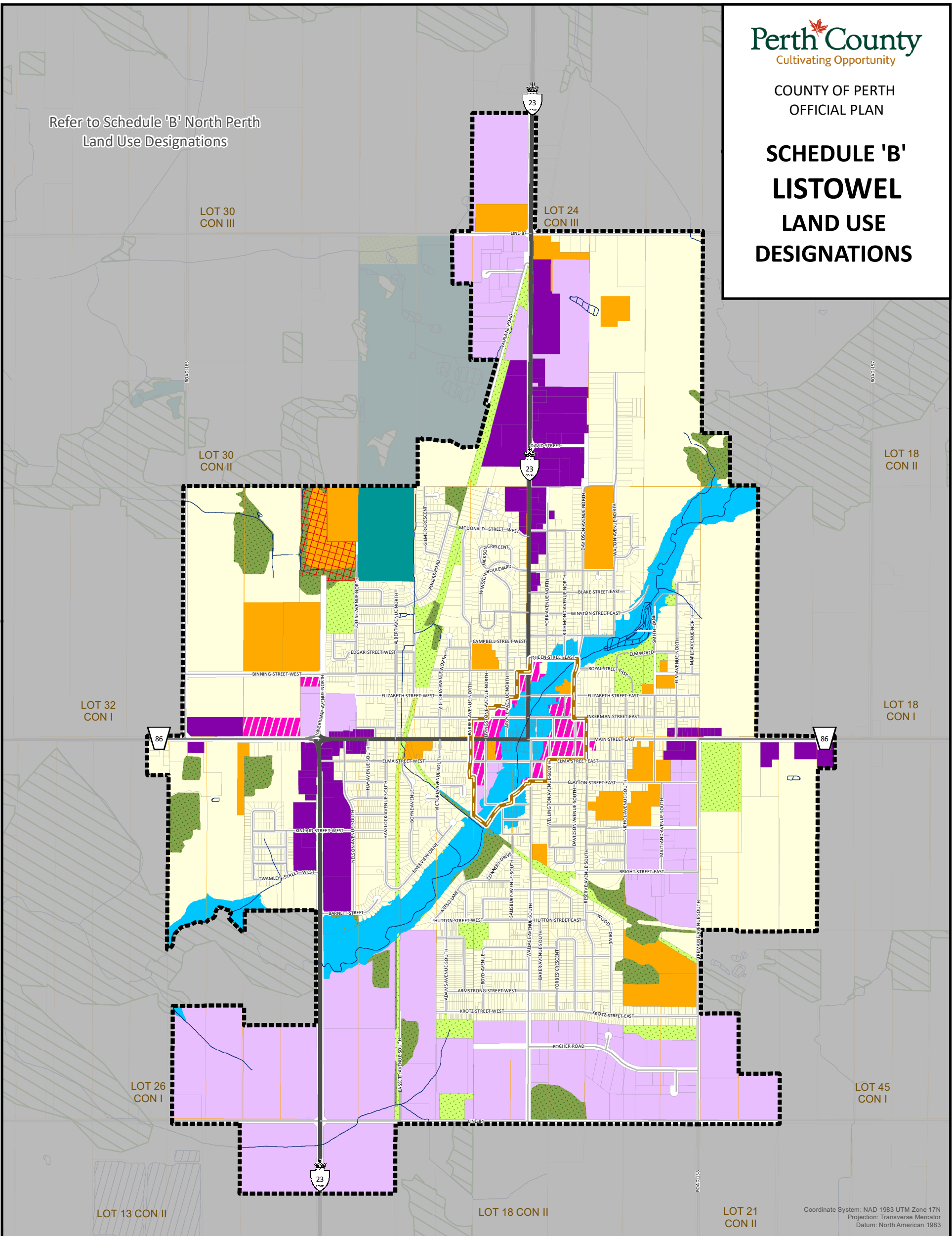

Coordinate System: NAD 1983 UTM Zone 17N
Projection: Transverse Mercator
Datum: North American 1983

LEGEND

Land Use Designations

- | | | | |
|--|---------------------|--|-----------------------------------|
| | Open Space | | Employment |
| | Natural Heritage | | Institutional |
| | Recreation | | Floodplain |
| | Neighbourhood | | Natural Heritage Features Overlay |
| | Urban Mixed Use | | |
| | Corridor Commercial | | |

Additional Features

- | | | | |
|--|--------------------|--|--------------------------|
| | Provincial Highway | | Strategic Growth Area |
| | County Road | | Settlement Area Boundary |
| | Local Road | | Closed Landfill |
| | Watercourse | | Waterbody |
| | | | Parcels |
| | | | Lots and Concessions |

0 240 480 720 m
Scale 1:20,000
1 cm = 200 m



This schedule forms a part of the County of Perth Official Plan and must be read in conjunction with applicable policies of the Plan. For accurate reference recourse should be had to the original document and amendments hereto. The County of Perth does not warrant the accuracy, completeness, content, or currency of the information provided. Contains information licensed under the Open Government Licence – Ontario. This is not a legal Plan of Survey. © The Corporation of Perth County, 2025.

This map may incorporate data under license from:
© King's Printer for Ontario, 2024
© Maitland Valley Conservation Authority, 2024
© Upper Thames River Conservation Authority, 2024
© Grand River Conservation Authority, 2024
© Ausable Bayfield Conservation Authority, 2024

SCHEDULE 'B'
MILLBANK
LAND USE
DESIGNATIONS

LOT 15
CON VII

LOT 16
CON VII

Refer to Schedule
'B' Perth East Land
Use Designations

72

121

72

LOT 15 CON VI

LOT 17 CON VI

Coordinate System: NAD 1983 UTM Zone 17N
Projection: Transverse Mercator
Datum: North American 1983

LEGEND

Land Use Designation

- Village
- Open Space
- Natural Heritage
- Floodplain
- Natural Heritage Features Overlay

Additional Features

- County Road
- Local Road
- Watercourse
- Former Railway Line
- Settlement Area Boundary
- Waterbody
- Parcels
- Lots and Concessions

0 90 180 270 m
Scale 1:7,500
1 cm = 75 m



This schedule forms a part of the County of Perth Official Plan and must be read in conjunction with applicable policies of the Plan. For accurate reference recourse should be had to the original document and amendments hereto. The County of Perth does not warrant the accuracy, completeness, content, or currency of the information provided. Contains information licensed under the Open Government Licence – Ontario. This is not a legal Plan of Survey. © The Corporation of Perth County, 2025.

This map may incorporate data under license from:
© King's Printer for Ontario, 2024
© Maitland Valley Conservation Authority, 2024
© Upper Thames River Conservation Authority, 2024
© Grand River Conservation Authority, 2024
© Ausable Bayfield Conservation Authority, 2024

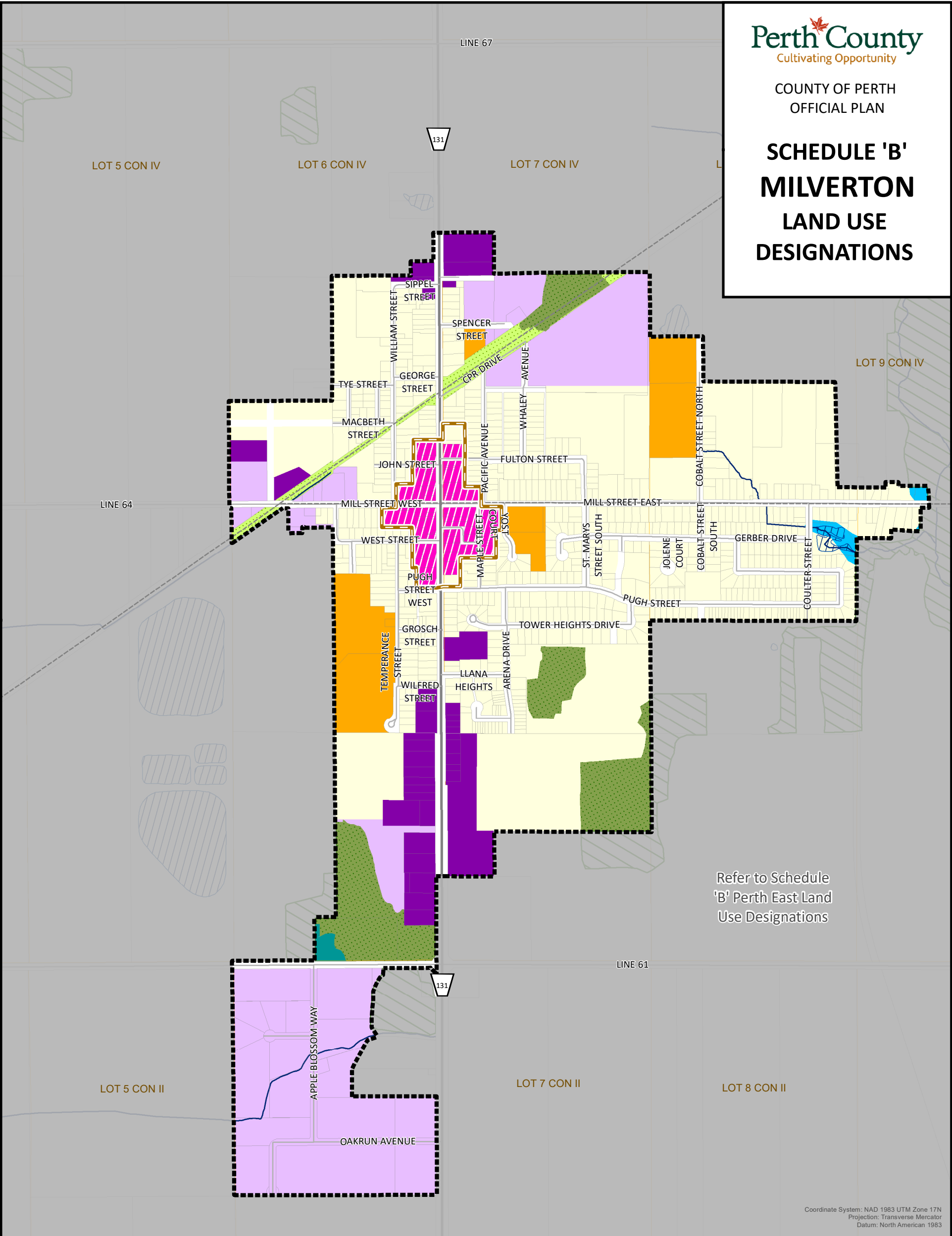

SCHEDULE 'B'
MILVERTON
LAND USE
DESIGNATIONS

LEGEND

Land Use Designation

- | | | | |
|--|---------------------|--|-----------------------------------|
| | Open Space | | Employment |
| | Natural Heritage | | Institutional |
| | Recreation | | Floodplain |
| | Neighbourhood | | Natural Heritage Features Overlay |
| | Urban Mixed Use | | |
| | Corridor Commercial | | |

Additional Features

- | | | | |
|--|---------------------|--|--------------------------|
| | County Road | | Strategic Growth Area |
| | Local Road | | Settlement Area Boundary |
| | Watercourse | | Closed Landfill |
| | Former Railway Line | | Waterbody |
| | | | Parcels |
| | | | Lots and Concessions |

0 130 260 390 m
Scale 1:11,000
1 cm = 110 m



This schedule forms a part of the County of Perth Official Plan and must be read in conjunction with applicable policies of the Plan. For accurate reference recourse should be had to the original document and amendments hereto. The County of Perth does not warrant the accuracy, completeness, content, or currency of the information provided. Contains information licensed under the Open Government Licence – Ontario. This is not a legal Plan of Survey. © The Corporation of Perth County, 2025.

This map may incorporate data under license from:
© King's Printer for Ontario, 2024
© Maitland Valley Conservation Authority, 2024
© Upper Thames River Conservation Authority, 2024
© Grand River Conservation Authority, 2024
© Ausable Bayfield Conservation Authority, 2024

SCHEDULE 'B'
MITCHELL
LAND USE
DESIGNATIONS

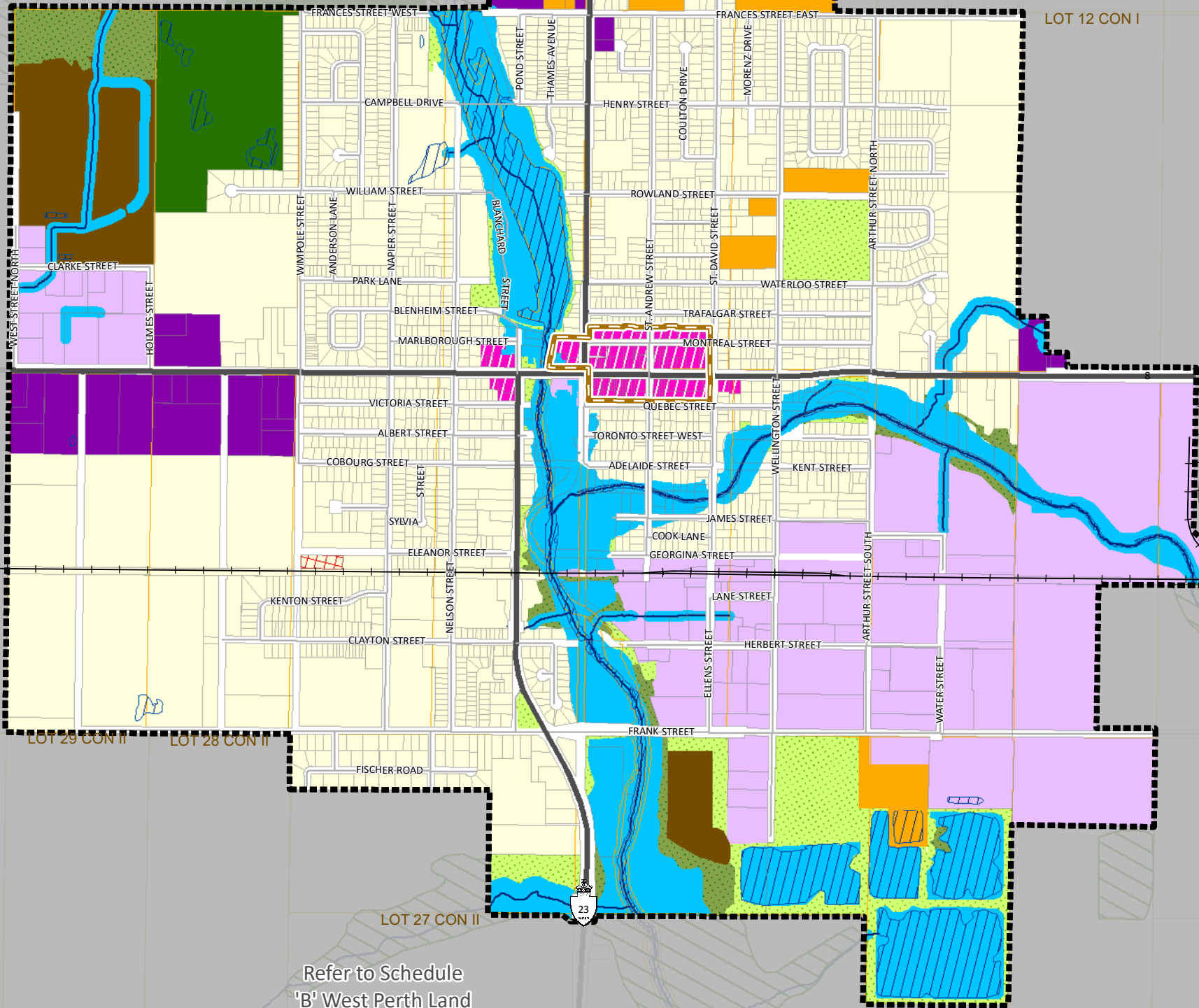

Refer to Schedule
'B' West Perth Land
Use Designations

LOT 12 CON I

LOT 19 CON II LOT 18 CON II LOT 17 CON II LOT 16 CON II LOT 15 CON II LOT 14 CON II LOT 13 CON II

23

LINE 36

23

LOT 27 CON II

LOT 25 CON II

LINE 32

Coordinate System: NAD 1983 UTM Zone 17N
Projection: Transverse Mercator
Datum: North American 1983

LEGEND

Land Use Designations

- | | | | |
|--|---------------------|--|-----------------------------------|
| | Open Space | | Employment |
| | Natural Heritage | | Institutional |
| | Recreation | | Open Landfill |
| | Neighbourhood | | Floodplain |
| | Urban Mixed Use | | Natural Heritage Features Overlay |
| | Corridor Commercial | | |

Additional Features

- | | | | |
|--|-----------------------|--|--------------------------|
| | Provincial Highway | | Strategic Growth Area |
| | County Road | | Settlement Area Boundary |
| | Local Road | | Waterbody |
| | Railway/ Right of Way | | Closed Landfill |
| | Watercourse | | Parcels |
| | | | Lots and Concessions |

0 180 360 540 m
Scale 1:15,000
1 cm = 150 m



This schedule forms a part of the County of Perth Official Plan and must be read in conjunction with applicable policies of the Plan. For accurate reference recourse should be had to the original document and amendments hereto. The County of Perth does not warrant the accuracy, completeness, content, or currency of the information provided. Contains information licensed under the Open Government Licence – Ontario. This is not a legal Plan of Survey. © The Corporation of Perth County, 2025.

This map may incorporate data under license from:
© King's Printer for Ontario, 2024
© Maitland Valley Conservation Authority, 2024
© Upper Thames River Conservation Authority, 2024
© Grand River Conservation Authority, 2024
© Ausable Bayfield Conservation Authority, 2024

SCHEDULE 'B'
MONKTON
LAND USE
DESIGNATIONS



Refer to Schedule
'B' North Perth Land
Use Designations

LINE 57

QUEEN AVENUE MONKTON

LOT 14
CON XVIII

NORTH PERTH
WEST PERTH

SCHADE STREET

Refer to Schedule
'B' West Perth Land
Use Designations

LOT 12
CON XVI

Coordinate System: NAD 1983 UTM Zone 17N
Projection: Transverse Mercator
Datum: North American 1983

LEGEND

Land Use Designations

- Village
- Open Space
- Floodplain
- Natural Heritage Features Overlay

Additional Features

- Provincial Highway
- County Road
- Local Road
- Former Railway Line
- Watercourse

- Settlement Area Boundary
- Parcels
- Lots and Concessions

0 70 140 210 m
Scale 1:6,000
1 cm = 60 m



This schedule forms a part of the County of Perth Official Plan and must be read in conjunction with applicable policies of the Plan. For accurate reference recourse should be had to the original document and amendments hereto. The County of Perth does not warrant the accuracy, completeness, content, or currency of the information provided. Contains information licensed under the Open Government Licence – Ontario. This is not a legal Plan of Survey. © The Corporation of Perth County, 2025.

This map may incorporate data under license from:
© King's Printer for Ontario, 2024
© Maitland Valley Conservation Authority, 2024
© Upper Thames River Conservation Authority, 2024
© Grand River Conservation Authority, 2024
© Ausable Bayfield Conservation Authority, 2024

SCHEDULE 'B'
NEWTON
LAND USE
DESIGNATIONS

Refer to Schedule 'B'
Perth East Land
Use Designations

LOT 9 CON VII

COMMUNITY CENTRE DRIVE

CRESCENT AVENUE

72

ROAD 129

HOLMES DRIVE

Coordinate System: NAD 1983 UTM Zone 17N
Projection: Transverse Mercator
Datum: North American 1983

LEGEND

Land Use Designation

- Village
- Natural Heritage
- Floodplain
- Natural Heritage Features Overlay

Additional Features

- County Road
- Local Road
- Watercourse

- Settlement Area Boundary
- Parcels
- Lots and Concessions

0 40 80 120 m
Scale 1:4,000
1 cm = 40 m



This schedule forms a part of the County of Perth Official Plan and must be read in conjunction with applicable policies of the Plan. For accurate reference recourse should be had to the original document and amendments hereto. The County of Perth does not warrant the accuracy, completeness, content, or currency of the information provided. Contains information licensed under the Open Government Licence – Ontario. This is not a legal Plan of Survey. © The Corporation of Perth County, 2025.

This map may incorporate data under license from:
© King's Printer for Ontario, 2024
© Maitland Valley Conservation Authority, 2024
© Upper Thames River Conservation Authority, 2024
© Grand River Conservation Authority, 2024
© Ausable Bayfield Conservation Authority, 2024